

# Sandow Unit 5

Affordable clean power from Texas lignite

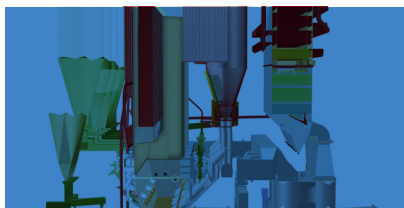
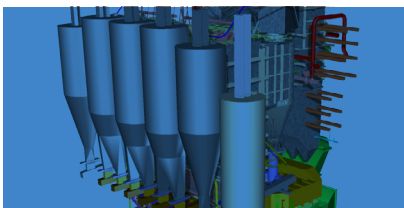

### Project summary

Location: Rockdale, TX, USA  
 Customer: Bechtel & TXU  
 Duration: 2006-2009  
 Scope: Design and supply of two CFB boilers

Luminant's Sandow Unit 5 is a 630 MWe (gross) power plant located in Rockdale, Texas. The plant features two Sumitomo SHI FW circulating fluidized bed boilers which convert high-ash, Texas lignite into valuable power for local homes and industrial facilities.

- ▶ Large scale, clean reliable and affordable power
- ▶ Two boilers supply single turbine generator
- ▶ Includes CFB polishing scrubbers
- ▶ On-site limestone sizing mills

<b>Plant Electrical Output (Gross/Net)</b>	2 x 315/2 x 283 MWe	
<b>Steam Flow (SH/RH)</b>	943/860 tph	2076/1896 kpph
<b>Steam Pressure (SH/RH)</b>	175/46 bar g	2545/669 psig
<b>Steam Temperature (SH/RH)</b>	542/539°C	1007/1002°F
<b>Feedwater Temperature</b>	260°C	500°F
<b>Fuel</b>	Texas lignite	

Metsänneidonkuja 10  
FI-02130 Espoo, Finland  
T +358 (0) 10 393 11

Relanderinkatu 2  
FI-78201 Varkaus, Finland  
T +358 (0) 10 393 11

ul. Staszica 31  
41-200 Sosnowiec, Poland  
T +48 (0) 32 368 1300

ul. Młynarska 42  
01-171 Warsaw, Poland  
T +48 (0) 22 535 50 65

Lindövägen 75  
602 28 Norrköping, Sweden  
T +46 (0) 11 285 330

Petersstrasse 120  
47798 Krefeld, Germany  
T +49 151 108 51366

53 Frontage Rd, PO Box 9000  
Hampton, NJ 08827 USA  
T +1 908 713 2700

Unit 01~07, 5th Floor,  
Shanghai Kaisa Financial Centre  
1188 Minsheng Rd, Pudong New Area  
Shanghai 200135, China  
T +86 (0) 21 5820 0123

C-3A-45, IOI Boulevard, Jalan Kenari 5,  
Bandar Puchong Jaya, 47100 Puchong,  
Selangor, Malaysia  
T +603 8075 0887

20th Floor Bhiraj Tower  
at EmQuartier, 689 Sukhumvit Rd  
Klongton Nuea, Wattana  
Bangkok 10110 Thailand  
T +66 (0) 2 0417140 3

Suite 706-708, 7th Floor, Central Bldg  
31 Hai Ba Trung St  
Hanoi, Vietnam  
T +84 (0) 4 39393809

7th floor, 621, Yeong-dong-daero,  
Gangnam-gu, Seoul, Korea 06087  
T +82 2 3446 8325

Room 901A, 9th Floor  
Vicente Madrigal Bldg, Ayala Ave  
Makati City 6793, Philippines

WISMA GKBI #1606, Jl. Jend. Sudirman No.28,  
Jakarta 10210 Indonesia  
T +62 (21) 5795 1095

ThinkPark Tower, 1-1 Osaki 2-chome  
Shinagawa-ku, Tokyo 141-6025, Japan  
T +81 (0) 3 6737 2000

[www.shi-fw.com](http://www.shi-fw.com)

Our vision is to provide sustainable energy solutions through decarbonization, decentralization and digitalization of the energy industry. Our capabilities cover customer needs in the fields of power generation utilizing circulating fluidized bed (CFB) technologies, long term energy storage, and related network services. We continuously broaden our portfolio of products and services by advancing our in-house technologies and developing further alliances with new partners.

## Our Values

### Respect for people.

Valuing and inviting differing views and ideas

### Committed to customers.

Exceeding expectations and providing value

### Safety, integrity and teamwork.

Incorporating ethics in everything we do

### Ownership of results.

Personally ensuring that success is achieved

### Passion to innovate and grow.

Setting challenging goals for growth



**Sumitomo**  
SHI **FW**